

LASAK BioniQ QR 3shape library structure

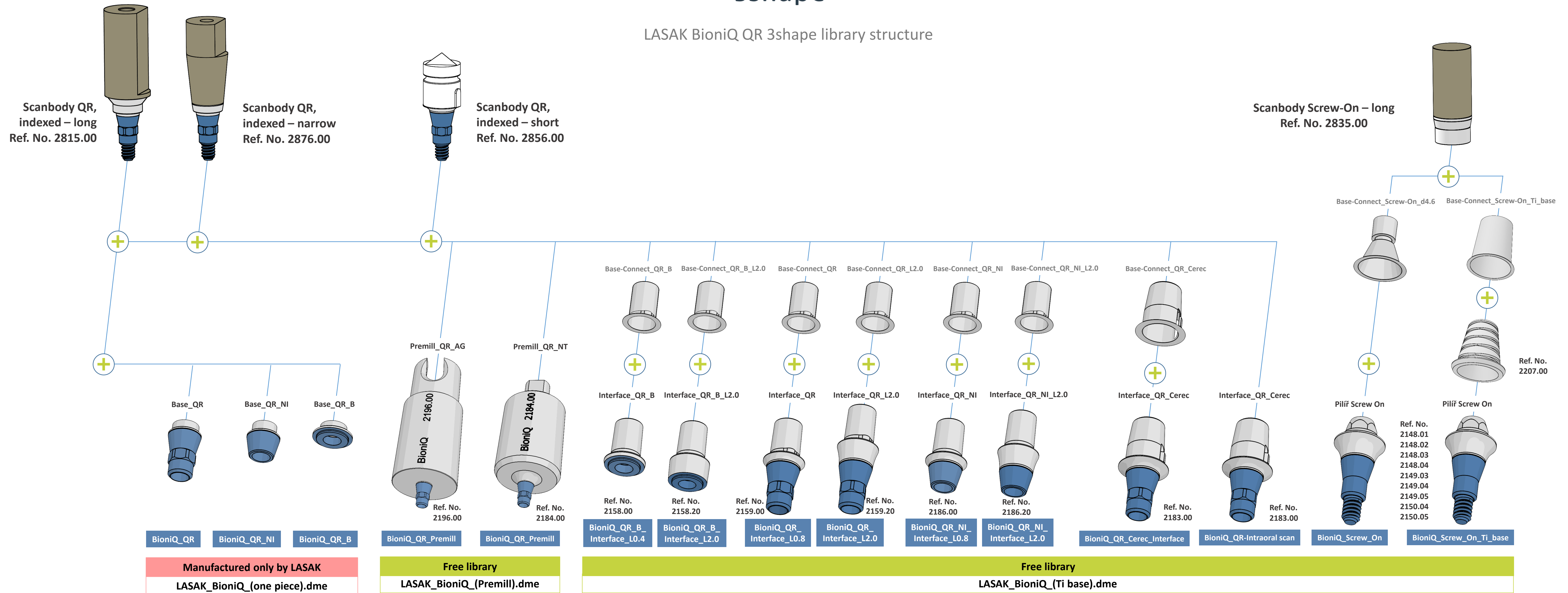

Ref. No.
2858.00

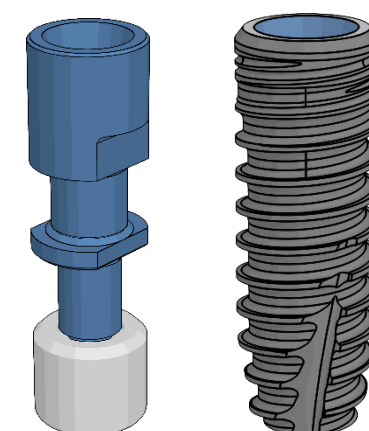

S3.5
S4.0
T4.0
S5.0
T5.0

LASAK BioniQ QN 3shape library structure

Scanbody QN, indexed – long
Ref. No. 2840.00

Scanbody QN, indexed – narrow
Ref. No. 2877.00

Scanbody QN, indexed – short
Ref. No. 2870.00

Scanbody Screw-On – long
Ref. No. 2835.00

Base-QN
Ref. No. 2187.00

Base-QN_NI
Ref. No. 2187.00

Base-QN_B
Ref. No. 2187.00

Premill_QN_AG
Ref. No. 2197.00

Premill_QN_NT
Ref. No. 2187.00

Interface_QN
Ref. No. 2181.00

Interface_QN_L2.0
Ref. No. 2181.20

Interface_QN_NI
Ref. No. 2189.00

Interface_QN_NI_L2.0
Ref. No. 2189.20

Pilif Screw-On
Ref. No. 2177.01
Ref. No. 2177.02
Ref. No. 2177.03
Ref. No. 2177.04

Pilif Screw-On
Ref. No. 2207.00

Base-Connect_Screw-On_d4.6

Base-Connect_Screw-On_Ti_base

Manufactured only by LASAK
Lasak_library_(one piece).dme

Free library
LASAK_BioniQ_(Premill).dme

Free library
LASAK_BioniQ_(Ti base).dme

S2.9